

C L Δ R K



Kitchen + Laundry

Choosing your sink.

Installation type.

Overmount or Undermount? An overmount sink is a traditional drop-in style sink with a lip that sits over the benchtop; is easy to install and is suitable for all benchtops. An undermount sink is installed underneath the benchtop and requires a solid surface like granite, marble or engineered stone.

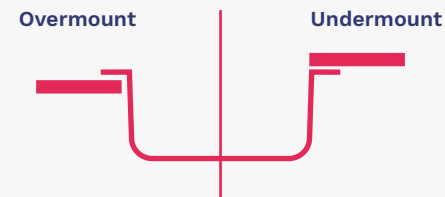

Cabinet size.

Check that your cabinet is wide enough (left to right) and deep enough (front to back) to accommodate your chosen sink.

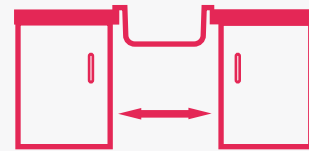

Bowl & drainer configuration.

There are numerous bowl and drainer configurations to choose from when selecting your kitchen sink and your choice will ultimately affect the function of your kitchen. The drainer and bowl location is also an important consideration as most sinks are available in left hand or right hand bowl configurations. Consider which option will work best in your space.



Single bowl sinks

A great fit for small kitchens, alfresco or butler's pantries. Available in overmount or undermount.



Double bowl sinks

A great fit for larger kitchens while maintaining a minimalist (drainer free) look.



Single bowl sinks with drainer

For smaller kitchens, studios or butler's pantries with the need for a handy drainage or prep area.



1.75 bowl sinks with drainer

A practical second bowl makes this an ideal sink for busy kitchens.



1.5 bowl sinks with drainer

Add a little more functionality. Perfect for those who need a little extra sink space or a rinsing bowl.



Double bowl sinks with drainer

An ideal working space for family sized kitchens and those who love to cook.

Bowl size.

While small bowls might take up less bench space, make sure you have a large enough bowl to suit your needs.



Contents.

Designed and engineered in Australia with over 75 years of experience and a lifetime warranty*, you can be confident that your CLARK sink will stand the test of time. Our sinks are manufactured from quality stainless steel so you know you're choosing a product that is both hygienic and 100% recyclable. Our extensive range includes solutions for all types of projects and can be paired with matching tapware to create a kitchen or laundry space you will love.

Clark Kitchen & Laundry

- 4 Prism
- 6 Polar
- 8 Round Bowl
- 10 Monaco
- 12 Punch
- 14 Vital
- 16 Cellini
- 17 Horizon
- 18 Advance
- 19 Benchmark
- 20 Radiant
- 21 Choosing Your Laundry Sink
- 22 Flushline
- 23 Square
- 24 Tub & Cabinets
- 26 Kitchen & Laundry Tapware
- 28 Technical Drawings

Prism.



Premium material

Manufactured from 1.2mm quality 304 grade stainless steel and features stainless steel basket wastes for maximum durability and hygiene.



Lifetime warranty

All CLARK sinks come with a lifetime warranty* for peace of mind.



Design

The Prism ranges features a 10mm internal bowl radius which is easy to clean while still providing a sleek, contemporary style. Prism can be installed as both undermount or overmount and features rear positioned wastes to maximise under bench space.



Prism Single Bowl Overmount/Undermount

Size: L440 x W440 x D200 MM
Capacity: 31L

Code: PPR10B (OTH)



Prism Single Large Bowl Overmount/Undermount

Size: L760 x W440 x D200 MM
Capacity: 54.5L

Code: PPR10LGB (OTH)



Prism 1.5 Bowl Overmount/Undermount

Size: L670 x W440 x D200 MM
Capacity: 31L(Lrg) / 14.5L(Sml)

Code: PPR15BLH (OTH, LHB) PPR15BRH (OTH, RHB)



Prism Double Bowl Overmount/Undermount

Size: L870 x W440 x D200 MM
Capacity: 31L(per bowl)

Code: PPR20B (OTH)

Included Accessory:



Stainless Steel Basket Waste

Push down to seal, pull up to drain and remove to empty.

Optional Accessories:

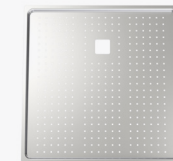

Prism Stainless Steel Drainer Tray

Code: A5016

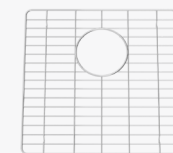

Prism Stainless Steel Bowl Saver

Designed to protect the bottom of the sink bowl.

Code: A0192



Prism Chopping Board & Stainless Steel Colander Set

Code: A0191

Polar.



Premium material

Manufactured from 1mm quality 304 grade stainless steel and features stainless steel basket wastes for maximum durability and hygiene.



Lifetime warranty

All CLARK sinks come with a lifetime warranty* for peace of mind.



Design

A versatile design with undermount and overmount configurations available. Rear positioned wastes maximise under bench space.



Polar Single Bowl Overmount

Size: L465 x W413 x D200 MM
Capacity: 26L

Code: PPL10B (OTH)



Polar Single Bowl Undermount

Size: L455 x W406 x D200 MM
Capacity: 26L

Code: PPL10BU (OTH)



Polar 1.5 Bowl Overmount

Size: L475 x W695 x D200 MM
Capacity: 26L(Lrg) / 16L(Sml)

Code: PPL15B (OTH, LHB) PPL15B.R (OTH, RHB)
PPL15B.1 (1TH, LHB) PPL15B.1R (1TH, RHB)



Polar 1.5 Bowl Undermount

Size: L455 x W695 x D200 MM
Capacity: 26L(Lrg) / 16L(Sml)

Code: PPL15BU (OTH)



Polar Double Bowl Overmount

Size: L475 x W795 x D200 MM
Capacity: 26L(per bowl)

Code: PPL20B (OTH) PPL20B.1 (1TH)



Polar Double Bowl Undermount

Size: L455 x W790 x D200 MM
Capacity: 26L(per bowl)

Code: PPL20BU (OTH)

Included Accessory:



Stainless Steel Basket Waste

Push down to seal, pull up to drain and remove to empty.

Optional Accessories:

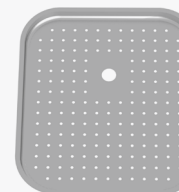

Polar Stainless Steel Drainer Tray

Code: A5015



Polar Stainless Steel Draining Basket

Code: A5014



Polar Timber Chopping Board

Code: A5013

Round Bowl.



Premium material

Manufactured from quality 304 grade stainless steel and features stainless steel basket wastes for maximum durability and hygiene.



Lifetime warranty

All CLARK sinks come with a lifetime warranty* for peace of mind.



Design

A timeless design with a practical round bowl makes this sink easy to clean and the perfect option for small spaces.



Round Bowl Overmount with Tap Landing

Size: L438 x W438 x D195 MM
Capacity: 22.5L

Code: 4012 (1TH)



Round Bowl Overmount

Size: L435 x W435 x D175 MM
Capacity: 20L

Code: 4010 (0TH)



Round Bowl Undermount

Size: L415 x W415 x D195 MM
Capacity: 22.5L

Code: 4011 (0TH)

Included Accessory:



Stainless Steel Basket Waste

Push down to seal, pull up to drain and remove to empty.

Monaco.



Premium material

Manufactured from quality 304 grade stainless steel and features stainless steel basket wastes for maximum durability and hygiene.



Lifetime warranty

All CLARK sinks come with a lifetime warranty* for peace of mind.



Design

A classic, comprehensive range of sinks featuring rear positioned wastes to maximise under bench space and include custom made accessories that transform your sink into a practical food preparation centre.



Monaco Single End Bowl

Size: L500 x W930 x D197 MM
Capacity: 20.2L

Code: 5113.0L (OTH, LHB) 5113.0R (OTH, RHB)
5113.1L (1TH, LHB) 5113.1R (1TH, RHB)



Monaco 1.75 End Bowl

Size: L500 x W1200 x D197 MM
Capacity: 20.2L(Lrg) / 14L(Sml)

Code: 5111.0L (OTH, LHB) 5111.0R (OTH, RHB) 5111.1L (1TH, LHB) 5111.1R (1TH, RHB)



Monaco Double End Bowl

Size: L500 x W1200 x D197 MM
Capacity: 20.2L(per bowl)

Code: 5100.0L (OTH, LHB) 5100.0R (OTH, RHB)
5100.1L (1TH, LHB) 5100.1R (1TH, RHB)



Monaco Single Bowl Overmount

Size: L462 x W382 x D190 MM
Capacity: 23L

Code: EVB (OTH)



Monaco Single Bowl Undermount

Size: L438 x W358 x D190 MM
Capacity: 23L

Code: EVBU (OTH)



Monaco 1.5 Bowl Undermount

Size: L470 x W623 x D190 MM
Capacity: 23L(Lrg) / 7.5L(Sml)

Code: EMDU.L (OTH, LHB) EMDU.R (OTH, RHB)



Monaco Double Bowl Undermount

Size: L470 x W750 x D190 MM
Capacity: 23L(per bowl)

Code: EXDU (OTH)



Monaco Scalloped Double Bowl Undermount

Size: L470 x W750 x D190 MM
Capacity: 23L(per bowl)

Code: 5908 (OTH)



Included Accessories:

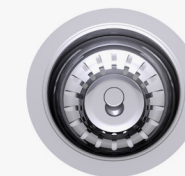

Stainless Steel Basket Waste

Push down to seal, pull up to drain and remove to empty.

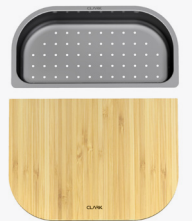

Chopping Board & Colander Set

Code: MHBC

Punch.



Premium material

Manufactured from quality 304 grade stainless steel and features stainless steel basket wastes for maximum durability and hygiene.



Lifetime warranty

All CLARK sinks come with a lifetime warranty* for peace of mind.



Design

A modern take on a traditional design, the Punch sink range is a practical and affordable option featuring a generous main bowl that can handle family sized washing up needs.



Punch Mega Bowl Sink

Size: L500 x W1100 x D200 MM

Capacity: 45L

Code: PU1211 (0TH, REV) PU1211.1L (1TH, LHB) PU1211.1R (1TH, RHB)



Punch Single End Bowl

Size: L500 x W860 x D180 MM
Capacity: 21L

Code: PU1203 (0TH, REV) PU1203.1L (1TH, LHB) PU1203.1R (1TH, RHB)



Punch 1.5 End Bowl

Size: L500 x W1000 x D180 MM
Capacity: 21L(Lrg) / 5.5L(Sml)

Code: PU1205 (0TH, REV) PU1205.1L (1TH, LHB) PU1205.1R (1TH, RHB)



Punch 1.75 End Bowl

Size: L500 x W1100 x D180 MM
Capacity: 21L(Lrg) / 11L(Sml)

Code: PU1207 (0TH, REV) PU1207.1L (1TH, LHB) PU1207.1R (1TH, RHB)



Punch Double End Bowl

Size: L500 x W1200 x D180 MM
Capacity: 21L(per bowl)

Code: PU1209 (0TH, REV) PU1209.1L (1TH, LHB) PU1209.1R (1TH, RHB)

Included Accessory:



Stainless Steel Basket Waste

Push down to seal, pull up to drain and remove to empty.

Optional Accessories - Punch Mega Bowl:



Punch Mega Bowl Mini Bowl

Designed to sit inside Punch Mega Bowl.

Code: PU1213



Punch Mega Bowl Chopping Board

Designed to suit Punch Mega Bowl.

Code: A5641

Vital.



Premium material

Manufactured from quality 304 grade stainless steel and features stainless steel basket wastes for maximum durability and hygiene.



Lifetime warranty

All CLARK sinks come with a lifetime warranty* for peace of mind.



Design

A compact and stylish solution for your kitchen with a bowl deep enough for a variety of uses, smooth, rounded corners and a functional, modern drainer.



Vital Single End Bowl

Size: L480 x W765 x D190 MM

Capacity: 19L

Code: 1123 (OTH, REV) 1123.1L (1TH, LHB) 1123.1R (1TH, RHB)



Vital 1.5 End Bowl

Size: L480 x W980 x D190 MM

Capacity: 19L(Lrg) / 7L(Sml)

Code: 1125.1L (1TH, LHB) 1125.1R (1TH, RHB)



Vital 1.75 End Bowl

Size: L480 x W1080 x D190 MM

Capacity: 19L(Lrg) / 11L(Sml)

Code: 1127 (OTH, REV) 1127.1L (1TH, LHB) 1127.1R (1TH, RHB)



Vital Double End Bowl

Size: L480 x W1180 x D190 MM

Capacity: 19L(per bowl)

Code: 1129 (OTH, REV) 1129.1L (1TH, LHB) 1129.1R (1TH, RHB)

Included Accessory:



Stainless Steel Basket Waste

Push down to seal, pull up to drain and remove to empty.

Optional Accessory:



Vital Large Timber Chopping Board

Fits large bowl of Vital range.

Code: A5810

Cellini.



Cellini Single Bowl with Tap Landing

Size: L505 x W505 x D170 MM
Capacity: 20L

Code: ERT.1 (1TH)



Cellini Single Bowl Overmount

Size: L458 x W458 x D175 MM
Capacity: 20L

Code: ERB (0TH)



Cellini Single Bowl Undermount

Size: L426 x W426 x D175 MM
Capacity: 20L

Code: ERBU (0TH)

Included Accessories:



Stainless Steel Basket Waste

Push down to seal, pull up to drain and remove to empty.



Cellini Timber Chopping Board

Round board that fits neatly over the bowl.



Stainless Steel Draining Basket

Fits neatly in the bowl for rinsing and draining, or next to the bowl for drying and stacking.

Horizon.



Horizon Single End Bowl

Size: L500 x W860 x D190 MM
Capacity: 24L

Code: HR3102 (0TH, REV) HR3102.1L (1TH, LHB)
HR3102.1R (1TH, RHB)



Horizon 1.75 End Bowl

Size: L500 x W1200 x D183 MM
Capacity: 24L(Lrg) / 18L(Sml)

Code: HR3107 (0TH, REV) HR3107.1L (1TH, LHB)
HR3107.1R (1TH, RHB)

Included Accessory:



Stainless Steel Basket Waste

Push down to seal, pull up to drain and remove to empty.



Advance.



Advance Single End Bowl
Size: L480 x W930 x D171 MM
Capacity: 20L
Code: 1503 (OTH, REV) 1503.1L (1TH, LHB) 1503.1R (1TH, RHB)



Advance 1.75 End Bowl
Size: L480 x W1230 x D161 MM
Capacity: 18.5L(Lrg) / 13.3L(Sml)
Code: 2503 (OTH, REV) 2503.1L (1TH, LHB) 2503.1R (1TH, RHB)



Advance Double End Bowl
Size: L480 x W1380 x D171 MM
Capacity: 20L(per bowl)
Code: 3501 (OTH, REV) 3501.1L (1TH, LHB) 3501.1R (1TH, RHB)



Advance Double Centre Bowl
Size: L480 x W1530 x D171 MM
Capacity: 20L(per bowl)
Code: 3507.1 (1TH)

Included Accessory:



Stainless Steel Basket Waste
Push down to seal, pull up to drain and remove to empty.

Benchmark.



Benchmark Single End Bowl
Size: L471 x W930 x D155 MM
Capacity: 13.5L
Code: 1003 (OTH, LHB) 1003.1 (1TH, LHB) 1003.3 (3TH, LHB) 1004 (OTH, RHB) 1004.1 (1TH, RHB) 1004.3 (3TH, RHB)



Benchmark Single Centre Bowl
Size: L471 x W1234 x D155 MM
Capacity: 13.5L
Code: 1012 (OTH) 1012.1 (1TH) 1012.3 (3TH)



Benchmark 1.5 Centre Bowl
Size: L471 x W1386 x D150 MM
Capacity: 13L(Lrg) 9L(Sml)
Code: 2009 (OTH, LHB) 2009.1 (1TH, LHB) 2009.3 (3TH, LHB) 2010 (OTH, RHB) 2010.1 (1TH, RHB) 2010.3 (3TH, RHB)



Benchmark Double Centre Bowl
Size: L471 x W1538 x D155 MM
Capacity: 13L(per bowl)
Code: 3007 (OTH) 3007.1 (1TH) 3007.3 (3TH)

Included Accessory:



Stainless Steel Basket Waste
Push down to seal, pull up to drain and remove to empty.

Radiant.



Radiant R110 Single End Bowl

Size: L470 x W820 x D164 MM
Capacity: 21L

Code: R110 (OTH, REV) R110.1L (1TH, LHB)
R110.1R (1TH, RHB)



Radiant R175 1.75 End Bowl

Size: L500 x W1200 x D155 MM
Capacity: 15.7L(Lrg) 13.1L(Sml)

Code: R175.1L (1TH, LHB) R175.1R (1TH, RHB)
R175.3L (3TH, LHB) R175.3R (3TH, RHB)



Stainless Steel Basket Waste

Push down to seal, pull up to drain and remove to empty.



Radiant R150 1.75 End Bowl

Size: L500 x W1100 x D152 MM
Capacity: 18L(Lrg) 12L(Sml)

Code: R150.1L (1TH, LHB) R150.1R (1TH, RHB)



Radiant R180 1.75 End Bowl

Size: L480 x W1230 x D161 MM
Capacity: 18.5L(Lrg) 13.3L(Sml)

Code: R180.1L (1TH, LHB) R180.1R (1TH, RHB)



Radiant R200 Double End Bowl

Size: L500 x W1200 x D154 MM
Capacity: 20L(per bowl)

Code: R200 (OTH, REV) R200.1L (1TH, LHB)
R200.1R (1TH, RHB)



Radiant MKII Double End Bowl

Size: L500 x W1200 x D160 MM
Capacity: 20L(per bowl)

Code: R175MK2.1L (1TH, LHB)
R175MK2.1R (1TH, RHB)

Choosing your laundry sink.

This decision will be based more on your individual needs as much as practical issues, like how much space you have in the laundry. Clark makes the decision easy, with a range of tubs to meet your requirements.



Standard or compact.

Most Clark laundry tubs are available in both standard and compact orientations. Compact tubs are ideal for small narrow areas and cupboard laundries where space is at a premium.



Standard flexible or concealed by-pass

Clark offers both standard flexible by-pass and concealed by-pass options. A concealed by-pass connection hides your washing machine by-pass hose under the bench or in the cabinet for a neat clutter free look.

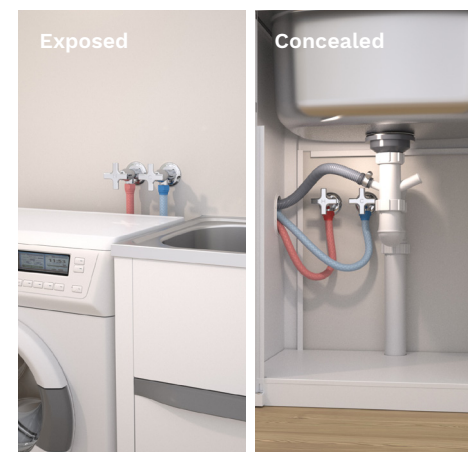

Exposed or Concealed Taps

Washing machine taps can either be installed exposed above the washing machine or can be cleverly hidden inside the cabinet. All Clark laundry tub and cabinets feature side entry holes which allow for the installation of concealed washing machine taps.

Flushline.



Single 30L Flushline Tub

Standard Size: L380 x W550 x D240 MM
Compact Size: L550 x W380 x D240 MM
Capacity: 30L

Code: 7610 (Compact with BY-PASS), 7500 (Standard or Compact NO BY-PASS), 7500.1L (1TH LH, NO BY-PASS), 7500.1R (1TH RH, NO BY-PASS), 7510 (Standard with BY-PASS)



Single 45L Flushline Tub

Standard Size: L480 x W640 x D267 MM
Compact Size: L640 x W480 x D267 MM
Capacity: 45L

CODE: 8500 (Standard or Compact, NO BY-PASS), 8510 (Standard with BY-PASS), 8500.1L (1TH LH, NO BY-PASS), 8500.1R (1TH RH, NO BY-PASS)



Single 70L Flushline Tub

Size: L560 x W634 x D300 MM
Capacity: 70L

Code: 9510 (BY-PASS)



Double 45L Flushline Tub

Size: L470 x W1243 x D260 MM
Capacity: 45L(per bowl)

Code: 8710 (0TH, BY-PASS) 8710.1 (1TH, BY-PASS)



45L Laundry Tub

Size: L486 x W650 x D248 MM
Capacity: 45L

Code: 8520 (BY-PASS)

Included Accessory:



Stainless Steel Basket Waste

Push down to seal, pull up to drain and remove to empty.

Optional Accessories:

Concealed By-Pass Kit

Hide your washing machine by-pass hose under the cabinet for a neat clutter free look.

CODE: A0196

Stainless Steel By-Pass Hole Cover

Cover for your washing machine by-pass hole.

CODE: Y4900

Square.



Square 25L Flushline Sink

Size: L500 x W360 x D230 MM
Capacity: 25L

Code: CL20003.0 (0TH) CL20003.1 (1TH)



Square 35L Flushline Sink

Size: L500 x W480 x D230 MM
Capacity: 35L

Code: CL20001.0 (0TH) CL20001.1 (1TH)



Square 45L Flushline Sink

Size: L500 x W580 x D230 MM
Capacity: 45L

Code: CL20002.0 (0TH) CL20002.1 (1TH)

Included Accessory:



Stainless Steel Basket Waste

Push down to seal, pull up to drain and remove to empty.



Tub & Cabinets.



Eureka 35L Tub & Cabinet Compact
Size: L606 x W380 x D873 MM
Capacity: 35L
Code: 7111 (BY-PASS) F7111 (Floor version*)



Eureka 45L Tub & Cabinet Standard
Size: L499 x W630 x D873 MM
Capacity: 45L
Code: 8011 (BY-PASS) F8011 (Floor version*) 8051 (OTH, CONCEALED BY-PASS) F8051 (Floor version*) 8051.1L (1TH LEFT, CONCEALED BY-PASS) F8051.1L (Floor version*) 8051.1R (1TH RIGHT, CONCEALED BY-PASS) F8051.1R (Floor version*)



Eureka 70L Tub & Cabinet Standard
Size: L586 x W630 x D873 MM
Capacity: 70L
Code: 9011 (BY-PASS) F9011 (Floor version*)



Eureka Double 45L Tub & Cabinet
Size: L498 x W1248 x D873 MM
Capacity: 45L(per bowl)
Code: 8211 (BY-PASS) F8211 (Floor version*)



Utility 42L Tub & Cabinet Compact
Size: L605 x W500 x D870 MM
Capacity: 42L
Code: F6111 (BY-PASS with floor)



Utility 42L Tub & Cabinet Standard
Size: L500 x W600 x D873 MM
Capacity: 42L
Code: F6001 (BY-PASS with floor)



Eureka 45L Tub & Cabinet Compact
Size: L655 x W473 x D873 MM
Capacity: 45L
Code: 8111 (BY-PASS) F8111 (Floor version*)



Utility 16.5L Mini Tub & Cabinet Compact
Size: L500 x W300 x D900 MM
Capacity: 16.5L
Code: 6611 (BY-PASS) F6611 (Floor version - supplied for VIC & QLD only)

Included Accessory:



Stainless Steel Basket Waste
Push down to seal, pull up to drain and remove to empty.

Optional Accessories:

Concealed By-Pass Kit
Hide your washing machine by-pass hose under the cabinet for a neat clutter free look.

CODE: A0196

Stainless Steel By-Pass Hole Cover
Cover for your washing machine by-pass hole.

CODE: Y4900

LEGEND

OTH = 0 tap hole, 1TH = 1 tap hole
NO BY-PASS = No by-pass or tap holes
BY-PASS = Includes one flexible by-pass kit & two by-pass holes
LEFT BY-PASS = Left by-pass hole, includes one flexible by-pass kit
RIGHT BY-PASS = Right by-pass hole, includes one flexible by-pass kit
CONCEALED BY-PASS = Includes one concealed by-pass kit
*Floor Version = Supplied for WA, VIC & QLD only

Kitchen & Laundry Tapware.



Round Pin Sink Mixer
WELS: 4 star rated, 7.5L/min
Code: CL10006.C4A (CHROME)
CL10006.B4A (MATTE BLACK)



Round Blade Sink Mixer
WELS: 4 star rated, 7.5L/min
Code: CL10017.C4A (CHROME)
CL10017.B4A (MATTE BLACK)



Round Square Sink Mixer
WELS: 4 star rated, 7.5L/min
Code: CL10026.C4A (CHROME)
CL10026.B4A (MATTE BLACK)



Cross Wall Sink Set
WELS: 4 star rated, 7.5L/min
Code: CL10042.C4A (CHROME)
CL10042.B4A (MATTE BLACK)



Cross Washing Machine Set
Code: CL10037.C (CHROME)
CL10037.B (MATTE BLACK)



Round Wall Sink Outlet
WELS: 4 star rated,
7.5L/min
Code: CL10038.C4A (CHROME)
CL10038.B4A (MATTE BLACK)

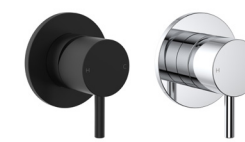

Round Pin Wall Mixer
Code: CL10027.C (CHROME)
CL10027.B (MATTE BLACK)



Round Blade Wall Mixer
Code: CL10029.C (CHROME)
CL10029.B (MATTE BLACK)



Round Square Wall Mixer
Code: CL10032.C (CHROME)
CL10032.B (MATTE BLACK)

Accessories:

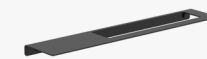

Square Hand Towel Rail
Length: 430 MM
Code: CL60027.B (MATTE BLACK)



Round Single Towel Rail
Length: 300 MM
Code: CL60019.C (CHROME) CL60019.B
(MATTE BLACK)



Round Robe Hook
Code: CL60017.C (CHROME)
CL60017.B (MATTE BLACK)

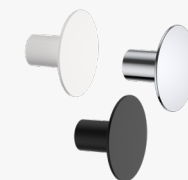

Round Wall Hook
Code: CL60025.C (CHROME) CL60025.B
(MATTE BLACK) CL60025.W (MATTE WHITE)

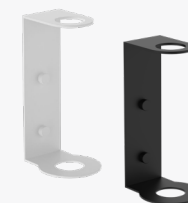

Round Soap Bottle Holder
Designed to suit 500ml pump bottles.
Code: CL60028.B (MATTE BLACK)
CL60028.W (MATTE WHITE)



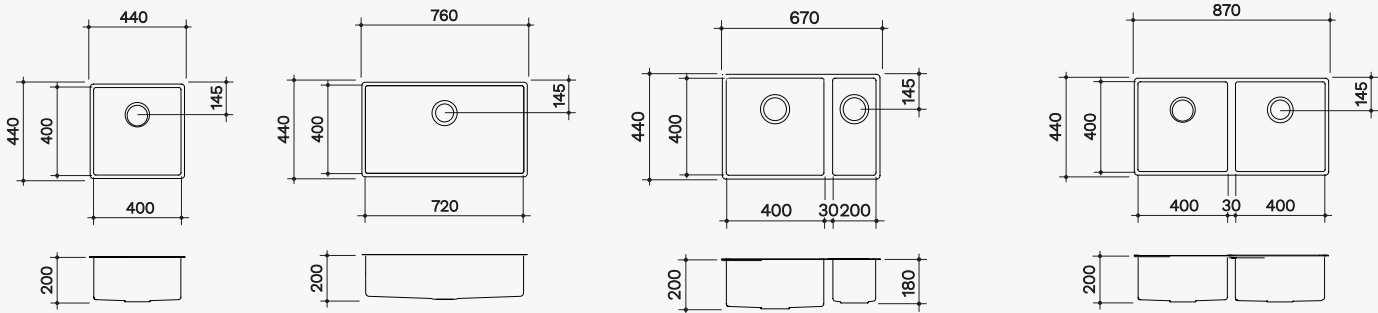

Prism Single Bowl Overmount/Undermount

Code: PPR10B (OTH)

Prism Single Large Bowl Overmount/Undermount

Code: PPR10LGB (OTH)

Prism 1.5 Bowl Overmount/Undermount

Code: PPR15BLH (OTH, LHB) PPR15BRH (OTH, RHB)

Prism Double Bowl Overmount/Undermount

Code: PPR20B (OTH)

Prism.

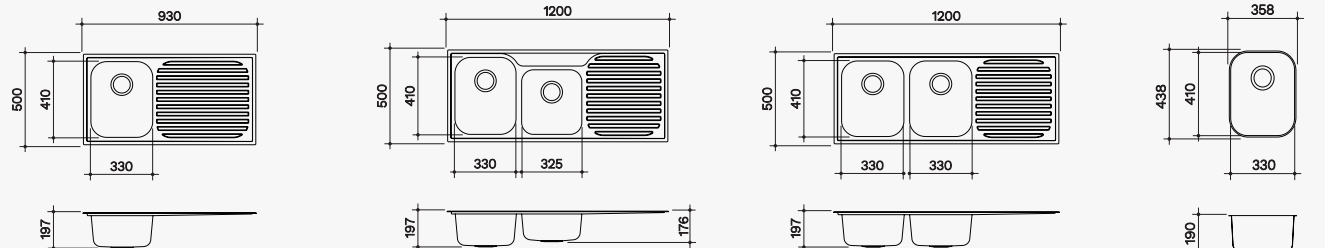

Monaco Single End Bowl

Code: 5113.0L (OTH, LHB) 5113.0R (OTH, RHB) 5113.1L (1TH, LHB) 5113.1R (1TH, RHB)

Monaco 1.75 End Bowl

Code: 5111.0L (OTH, LHB) 5111.0R (OTH, RHB) 5111.1L (1TH, LHB) 5111.1R (1TH, RHB)

Monaco Double End Bowl

Code: 5100.0L (OTH, LHB) 5100.0R (OTH, RHB) 5100.1L (1TH, LHB) 5100.1R (1TH, RHB)

Monaco Single Bowl Undermount

Code: EVBU (OTH)

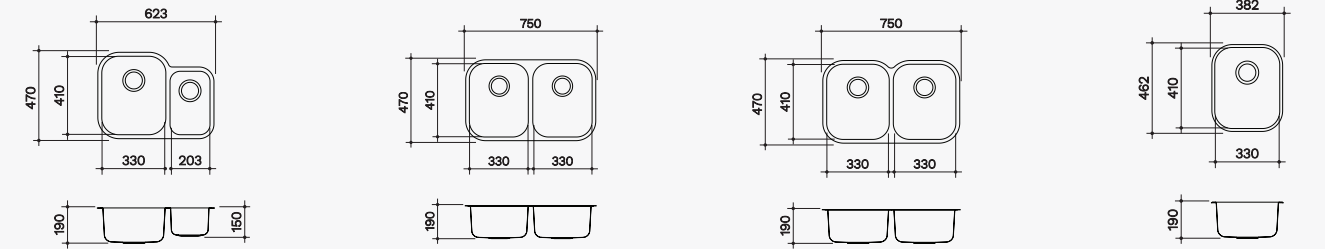

Monaco 1.5 Bowl Undermount

Code: EMDU.L (OTH, LHB) EMDU.R (OTH, RHB)

Monaco Double Bowl Undermount

Code: EXDU (OTH)

Monaco Scalloped Double Bowl Undermount

Code: 5908 (OTH)

Monaco Single Bowl Overmount

Code: EVB (OTH)

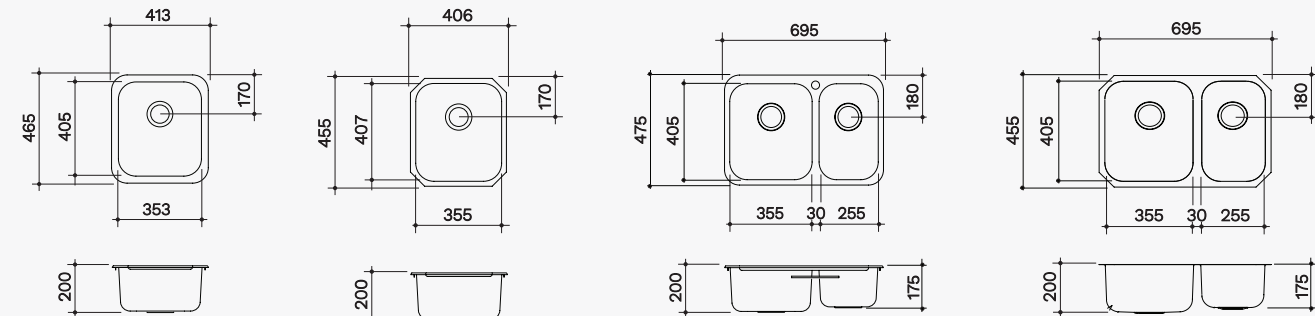

Polar Single Bowl Overmount

Code: PPL10B (OTH)

Polar Single Bowl Undermount

Code: PPL10BU (OTH)

Polar 1.5 Bowl Overmount

Code: PPL15B (OTH, LHB) PPL15B.R (OTH, RHB) PPL15B.1 (1TH, LHB) PPL15B.1R (1TH, RHB)

Polar 1.5 Bowl Undermount

Code: PPL15BU (OTH)

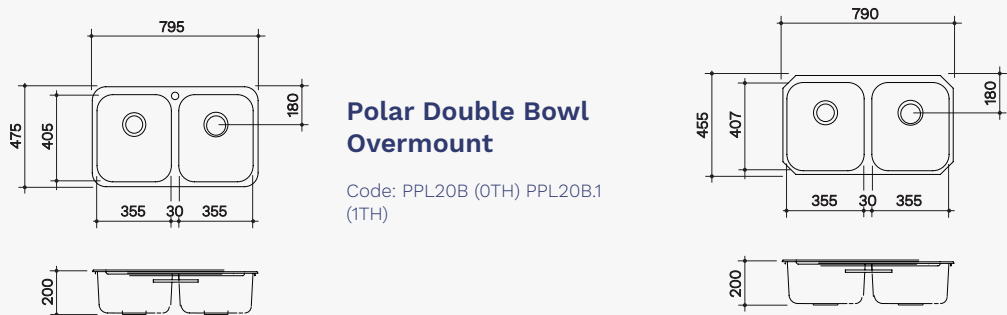

Polar Double Bowl Overmount

Code: PPL20B (OTH) PPL20B.1 (1TH)

Polar Double Bowl Undermount

Code: PPL20BU (OTH)

Polar.

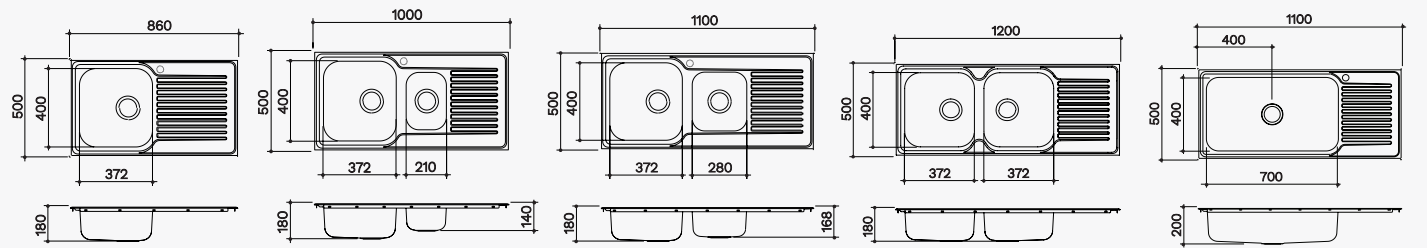

Punch Single End Bowl

Code: PU1203 (OTH, REV) PU1203.1L (1TH, LHB) PU1203.1R (1TH, RHB)

Punch 1.5 End Bowl

Code: PU1205 (OTH, REV) PU1205.1L (1TH, LHB) PU1205.1R (1TH, RHB)

Punch 1.75 End Bowl

Code: PU1207 (OTH, REV) PU1207.1L (1TH, LHB) PU1207.1R (1TH, RHB)

Punch Double End Bowl

Code: PU1209 (OTH, REV) PU1209.1L (1TH, LHB) PU1209.1R (1TH, RHB)

Punch Mega Bowl Sink

Code: PU1211 (OTH, REV) PU1211.1L (1TH, LHB) PU1211.1R (1TH, RHB)

Punch.

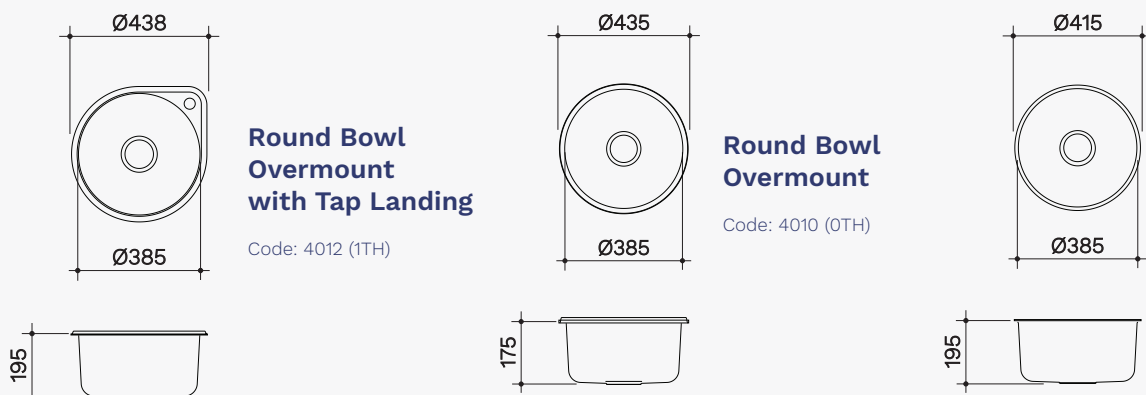

Round Bowl Overmount with Tap Landing

Code: 4012 (1TH)

Round Bowl Overmount

Code: 4010 (OTH)

Round Bowl Undermount

Code: 4011 (OTH)

Round Bowl.

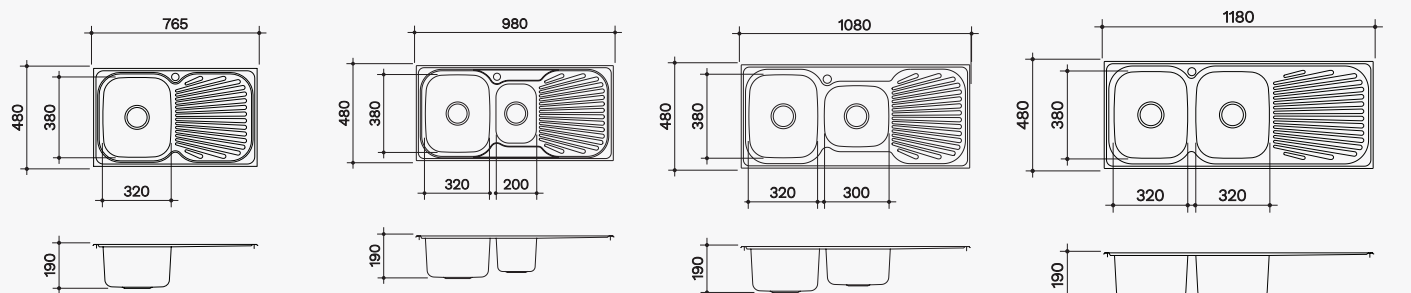

Vital Single End Bowl

Code: 1123 (OTH, REV) 1123.1L (1TH, LHB) 1123.1R (1TH, RHB)

Vital 1.5 End Bowl

Code: 1125.1L (1TH, LHB) 1125.1R (1TH, RHB)

Vital 1.75 End Bowl

Code: 1127 (OTH, REV) 1127.1L (1TH, LHB) 1127.1R (1TH, RHB)

Vital Double End Bowl

Code: 1129 (OTH, REV) 1129.1L (1TH, LHB) 1129.1R (1TH, RHB)

Vital.

Cellini Single Bowl with Tap Landing

Code: ERT.1 (1TH)

Cellini Single Bowl Overmount

Code: ERB (OTH)

Cellini Single Bowl Undermount

Code: ERBU (OTH)

Cellini.

Radiant R110 Single End Bowl

Code: R110 (OTH, REV) R110.1L (1TH, LHB) R110.1R (1TH, RHB)

Radiant R175 1.75 End Bowl

Code: R175.1L (1TH, LHB) R175.1R (1TH, RHB) R175.3L (3TH, LHB) R175.3R (3TH, RHB)

Radiant R150 1.75 End Bowl

Code: R150.1L (1TH, LHB) R150.1R (1TH, RHB)

Radiant R180 1.75 End Bowl

Code: R180.1L (1TH, LHB) R180.1R (1TH, RHB)

Radiant.

Horizon Single End Bowl

Code: HR3102 (OTH, REV) HR3102.1L (1TH, LHB) HR3102.1R (1TH, RHB)

Horizon 1.75 End Bowl

Code: HR3107 (OTH, REV) HR3107.1L (1TH, LHB) HR3107.1R (1TH, RHB)

Horizon.

Radiant R200 Double End Bowl

Code: R200 (OTH, REV) R200.1L (1TH, LHB) R200.1R (1TH, RHB)

Radiant MKII Double End Bowl

Code: R175MK2.1L (1TH, LHB) R175MK2.1R (1TH, RHB)

Advance Single End Bowl

Code: 1503 (OTH, REV) 1503.1L (1TH, LHB) 1503.1R (1TH, RHB)

Advance 1.75 End Bowl

Code: 2503 (OTH, REV) 2503.1L (1TH, LHB) 2503.1R (1TH, RHB)

Advance Double Centre Bowl

Code: 3507.1 (1TH)

Advance Double End Bowl

Code: 3501 (OTH, REV) 3501.1L (1TH, LHB) 3501.1R (1TH, RHB)

Advance.

Square 25L Flushline Sink

Code: CL20003.0 (OTH) CL20003.1 (1TH)

Square 35L Flushline Sink

Code: CL20001.0 (OTH) CL20001.1 (1TH)

Square 45L Flushline Sink

Code: CL20002.0 (OTH) CL20002.1 (1TH)

45L Laundry Tub

Code: 8520 (BY-PASS)

Square & Flushline.

Benchmark Single End Bowl

Code: 1003 (OTH, LHB) 1003.1 (1TH, LHB) 1003.3 (3TH, LHB) 1004 (OTH, RHB) 1004.1 (1TH, RHB) 1004.3 (3TH, RHB)

Benchmark Single Centre Bowl

Code: 1012 (OTH) 1012.1 (1TH) 1012.3 (3TH)

Benchmark 1.5 Centre Bowl

Code: 2009 (OTH, LHB) 2009.1 (1TH, LHB) 2009.3 (3TH, LHB) 2010 (OTH, RHB) 2010.1 (1TH, RHB) 2010.3 (3TH, RHB)

Benchmark Double Centre Bowl

Code: 3007 (OTH) 3007.1 (1TH) 3007.3 (3TH)

Benchmark.

Single 30L Flushline Tub

Code: 7610 (Compact with BY-PASS), 7500 (Standard or Compact NO BY-PASS), 7500.1L (1TH LH, NO BY-PASS), 7500.1R (1TH RH, NO BY-PASS), 7510 (Standard with BY-PASS)

Single 70L Flushline Tub

Code: 9510 (BY-PASS)

Single 45L Flushline Tub

CODE: 8500 (Standard or Compact, NO BY-PASS), 8510 (Standard with BY-PASS), 8500.1L (1TH LH, NO BY-PASS) 8500.1R (1TH RH, NO BY-PASS)

Double 45L Flushline Tub

Code: 8710 (OTH, BY-PASS) 8710.1 (1TH, BY-PASS)

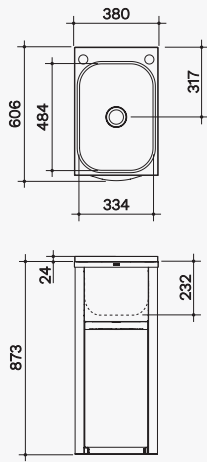

Eureka 35L Tub & Cabinet Compact
Capacity: 35L

Code: 7111 (BY-PASS) F7111 (Floor version)

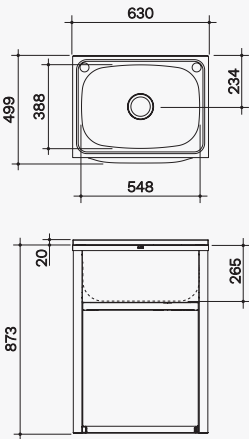

Eureka 45L Tub & Cabinet Standard
Capacity: 45L

Code: 8011 (BY-PASS) F8011 (Floor version) 8051 (OTH, CONCEALED BY-PASS) F8051 (Floor version) 8051.1L (1TH LEFT, CONCEALED BY-PASS) F8051.1L (Floor version) 8051.1R (1TH RIGHT, CONCEALED BY-PASS) F8051.1R (Floor version)

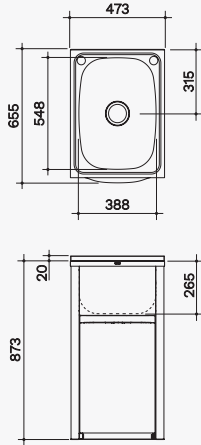

Eureka 45L Tub & Cabinet Compact
Capacity: 45L

Code: 8111 (BY-PASS) F8111 (Floor version)

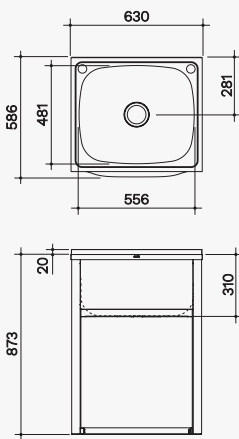

Eureka 70L Tub & Cabinet Standard
Capacity: 70L

Code: 9011 (BY-PASS) F9011 (Floor version)

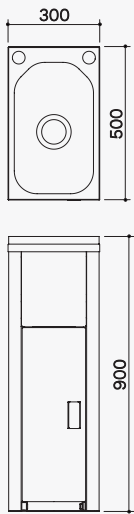

Utility 16.5L Mini Tub & Cabinet Compact
Capacity: 16.5L

Code: 6611 (BY-PASS) F6611 (Floor version - supplied for VIC & QLD only)

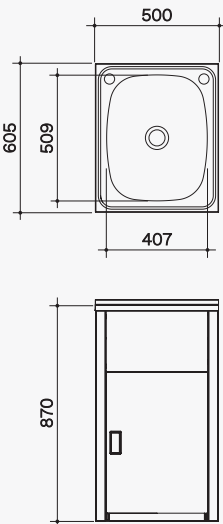

Utility 42L Tub & Cabinet Compact
Capacity: 42L

Code: F6111 (BY-PASS with floor)

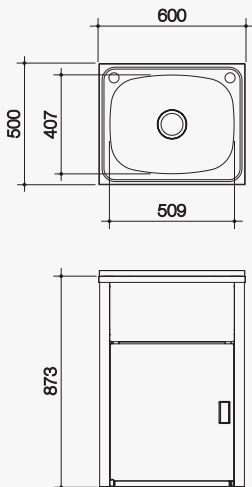

Utility 42L Tub & Cabinet Standard
Capacity: 42L

Code: F6001 (BY-PASS with floor)

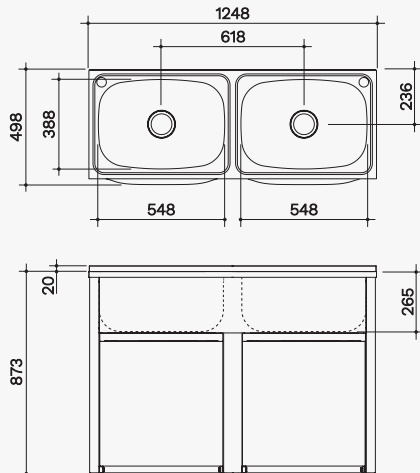

Eureka Double 45L Tub & Cabinet
Capacity: 45L(per bowl)

Code: 8211 (BY-PASS) F8211 (Floor version)

Tub & Cabinets.

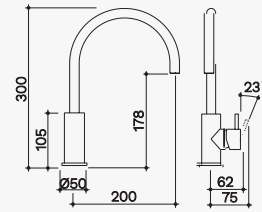

Round Pin Sink Mixer

Code: CL10006.C4A (CHROME)
CL10006.B4A (MATTE BLACK)

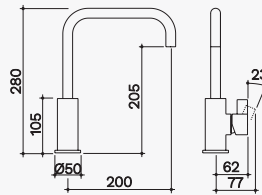

Round Blade Sink Mixer

Code: CL10017.C4A (CHROME)
CL10017.B4A (MATTE BLACK)

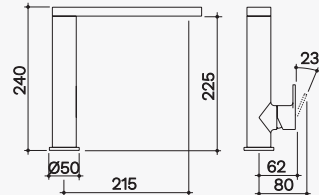

Round Square Sink Mixer

Code: CL10026.C4A (CHROME)
CL10026.B4A (MATTE BLACK)

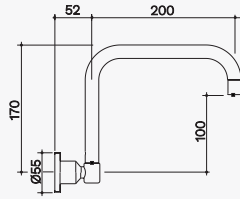

Round Wall Sink Outlet

Code: CL10038.C4A (CHROME)
CL10038.B4A (MATTE BLACK)

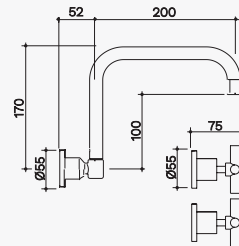

Cross Wall Sink Set

Code: CL10042.C4A (CHROME)
CL10042.B4A (MATTE BLACK)

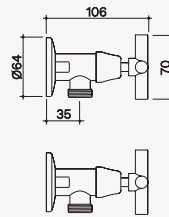

Cross Washing Machine Set

Code: CL10037.C (CHROME)
CL10037.B (MATTE BLACK)

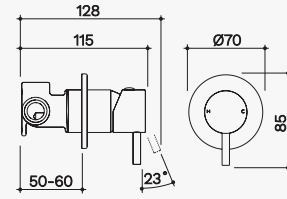

Round Pin Wall Mixer

Code: CL10027.C (CHROME)
CL10027.B (MATTE BLACK)

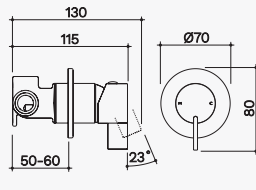

Round Blade Wall Mixer

Code: CL10029.C (CHROME)
CL10029.B (MATTE BLACK)

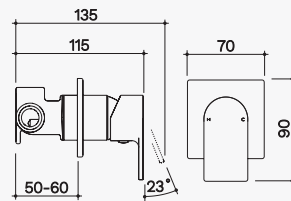

Round Square Wall Mixer

Code: CL10032.C (CHROME)
CL10032.B (MATTE BLACK)

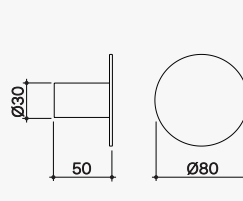

Round Wall Hook

Code: CL60025.C (CHROME)
CL60025.B (MATTE BLACK)
CL60025.W (MATTE WHITE)

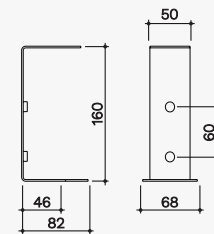

Round Soap Bottle Holder

Code: CL60028.B (MATTE BLACK)
CL60028.W (MATTE WHITE)

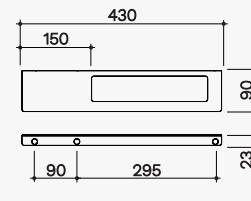

Square Hand Towel Rail

Code: CL60027.B (MATTE BLACK)

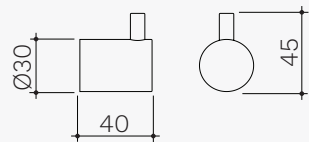

Round Robe Hook

Code: CL60017.C (CHROME)
CL60017.B (MATTE BLACK)

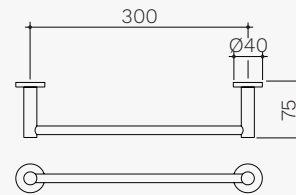

Round Single Towel Rail 300mm

Code: CL60019.C (CHROME)
CL60019.B (MATTE BLACK)

LEGEND

OTH = 0 tap hole, 1TH = 1 tap hole
NO BY-PASS = No by-pass or tap holes
BY-PASS = Includes one flexible by-pass kit & two by-pass holes
LEFT BY-PASS = Left by-pass hole, includes one flexible by-pass kit
RIGHT BY-PASS = Right by-pass hole, includes one flexible by-pass kit
CONCEALED BY-PASS = Includes one concealed by-pass kit
Floor Version = Supplied for WA, VIC & QLD only



GWA
Bathrooms & Kitchens

For more information on CLARK visit
clark.com.au

P. 13 14 16



© Copyright 2020 Caroma Industries Ltd. ABN 35 000 189 499. Caroma Industries Ltd has a policy of continuous improvement on its products and reserves the right to change materials and specifications without notice. Information herein is current at the time of printing and is subject to change without notice. WARNING: Products in this brochure are the subject of registered designs and patents. Sink images are digital representations which may vary from actual product samples. Tapware shown on sinks is not included and is sold separately. Please check actual product sample prior to purchase. For accurate cutout sizes only use templates provided with packaging.